

DL35 INSTALLATION INSTRUCTIONS

IMPORTANT

Read carefully before installing fixture. Retain instructions for future reference.

THIS PRODUCT MUST BE INSTALLED IN ACCORDANCE WITH THE APPLICABLE INSTALLATION CODE BY A PERSON FAMILIAR WITH THE CONSTRUCTION AND OPERATION OF THE PRODUCT AND THE HAZARDS INVOLVED. CONSULT A QUALIFIED ELECTRICIAN TO ENSURE CORRECT BRANCH CIRCUIT CONDUCTOR.

WARNING: RISK OF FIRE OR ELECTRICAL SHOCK.

WARNING: Make certain power is OFF before installing or maintaining fixture.

WARNING: Suitable for installation only in accessible ceilings. Access above the ceiling is required.

WARNING: Do not install insulation within 3 in (76mm) of any part of the Luminaire.

WARNING: SUITABLE FOR DRY OR DAMP LOCATIONS ONLY.

1. MAKE CEILING CUTOUT.

Please refer to ceiling cutout dimensions below.

Product	Ceiling Cutout
Round	2¾"
Square	1⅞"

(FIG. 1)

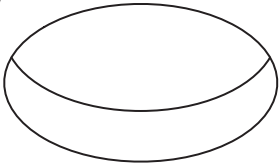

FOR NON-REMOTE OPTION

1A. INSTALL LOOSE JUNCTION BOX (NON-REMOTE OPTION).

For non-remote option, install the loose junction box prior to Step 2 (Fig. 2). Do this by pulling the existing conduit through cutout and making the proper connections (wiring diagrams Fig. 4 and Fig. 5).

(FIG. 2)

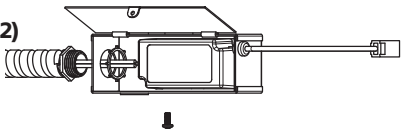

1B. CLOSE JUNCTION BOX, REPLACE SCREW AND INSERT JUNCTION BOX INTO CEILING CUTOUT.

Leave junction box output wiring accessible from below the ceiling.

NOTE: Ensure that installation complies with the local and national codes. If necessary, mount to nearby joist using self-tapping screw inside of the junction box away from wiring.

NOTE: Junction box to be installed where it will NOT be subjected to any movement.

(FIG. 3)

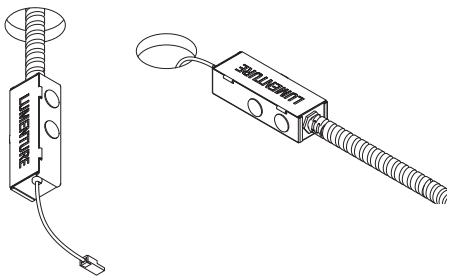

WIRING

Note: Driver permits operation at 120V through 277V, 50Hz or 60Hz. For non dimming and triac and electronic low voltage (ELV) dimming, follow wiring directions in Fig. 4.

1. Connect Ground wire from fixture to supply ground.
 2. Connect black fixture lead to (+) Line supply lead.
 3. Connect white fixture lead to (-) Common supply lead.
- For 0 - 10V dimming, follow wiring directions in Fig. 5.

(FIG. 4)

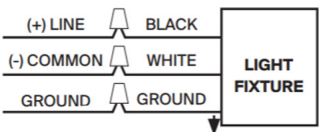

(FIG. 5)

For 0-10V dimming

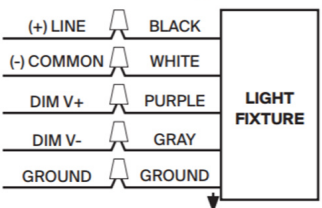

DL35 INSTALLATION INSTRUCTIONS

2. SECURE MUDPLATE TO CEILING.

NOTE: Pull low voltage wiring through opening prior to installing the mudplate.

(FIG. 6)

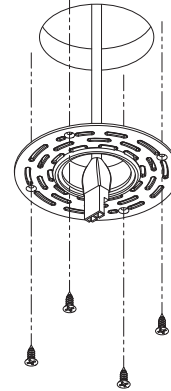

3. FINISH CEILING.

Finish the ceiling to conceal the mudplate.

(FIG. 7)

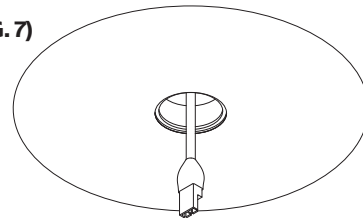

4. MAKE POWER CONNECTION.

Make low voltage connection between the module and power supply.

(FIG. 8)

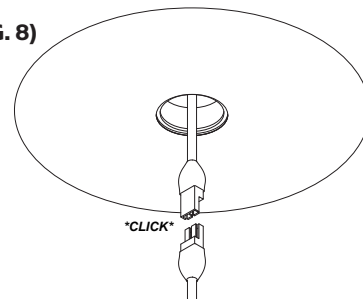

5. INSERT MODULE.

Insert module into ceiling cutout. Press firmly until module is completely flush with the ceiling.

(FIG. 9)

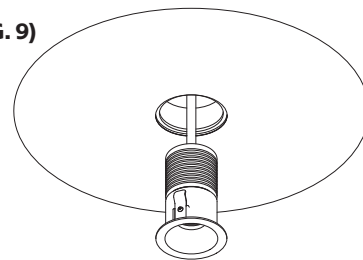

DL35 REMOTE WIRING INSTRUCTIONS

All wiring leads will be pre-wired in the remote housing and may be connected directly to the fixture/s immediately from the factory. Reference below for on-site extensions and installs. **NOTE:** The driver configuration **MUST** match the number of fixtures connected.

